

## PRODUCT SPECS

# FAN COILS

## HEFA 80, 200 and 600

Heat Exchanger Fluid to Air  
For Heating and Drying

### HEFA 80



### HEFA 200



### HEFA 600



## FEATURES

- Ideal for heating, drying and climate control applications.
- Their compact and mobile design allows them to be positioned where required on the job site.
- The efficient fan/coil design provides a high rate of heat transfer with built-in high volume fans that provide the heat delivery.
- High volume air flow ensures when heating, there is even heat distribution throughout the structure.
- When drying, ensures required air flow to effectively exhaust moisture-laden air from the structure.
- Clean, low humidity heat delivery minimizes energy costs. With the DryAir system, you just recirculate and re-heat warm inside air, rather than heating cold outside air.
- Provides the low humidity environment control essential for inhibiting mold growth and the optimum project application environment for interior finish work.
- Allows for daily application of joint compound or finish texture to drywall.
- Minimizes expansion and contraction of wallboard.
- Reduces amount of downtime between finished drywall and paint application.
- Eliminates shading of paint caused by residue from open flame heaters.
- Allows better adhesion of caulking materials.
- Provides a drier surface for application of water-based carpet and tile adhesives, epoxy and urethane coatings and epoxy joint fillers.
- Reduces the chance of shrinkage at mitered joints in finish trim materials.



400 Service Road, St. Brieux, SK, S0K 3V0 Canada

1-888-750-1700 | [WWW.DRYAIR.CA](http://WWW.DRYAIR.CA)

# PRODUCT SPECS

# FAN COILS

## HEFA 80, 200 and 600 *cont'd*

	HEFA 80	HEFA 200	HEFA 600
Heating Output <sup>1</sup>	80,187 BTU	201,364 BTU	512,418 BTU
Air Flow	900 CFM	2,300 CFM	5,000 CFM
Fluid Flow (Recommended)	6 GPM	15 GPM	30 GPM
Temp. Set Range	-30°F to 100°F (-34°C to 38°C) <i>Optional: 25°F to 225°F</i>	-30°F to 100°F (-34°C to 38°C) <i>Optional: 25°F to 225°F</i>	N/A
Fluid Connection • Single supply and return • ISO B Series Q.C.	¾" Quick Coupling	1" Quick Coupling	1" Quick Coupling
Fluid Circulation Lines • 300 P.S.I. heavy-duty "Explorer Air" hose	¾" I.D. x 50'	1" I.D. x 50'	1 ¼" I.D. x 50'
Blower	Backward inclined	G Series double inlet	Axial flow
Motor	.6 HP, 1-speed	1 HP, 3-speed	1 HP, 3-speed
Coil • Aluminum fin	2-row copper tube	3-row copper tube	3-row copper tube
Electrical	• 120 V, single phase, 60 Hz • 3.8 A	• 120 V, single phase, 60 Hz • 12.7 A	• 120 V, single phase, 60 Hz • 12.7 A
Controls	Thermostatic temperature control	Thermostatic temperature control	N/A
Wheels	2" Casters (4)	10" Flat-free (2)	8" Tube-style (2)
Weight	40 kg (90 lbs)	95 kg (210 lbs)	254 kg (560 lbs)
Cabinet	Stainless steel	Stainless steel	Powder-coated

1 - Based on 200°F (93°C) supply fluid and 32°F (0°C) ambient air.

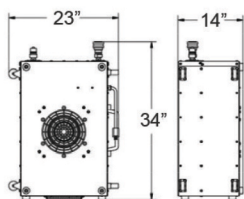

Dimensions: 23" l x 14" w x 34" h

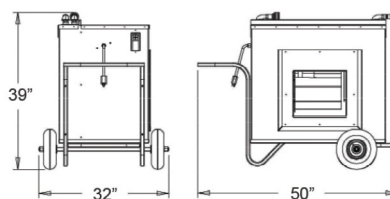

Dimensions: 50" l x 32" w x 39" h

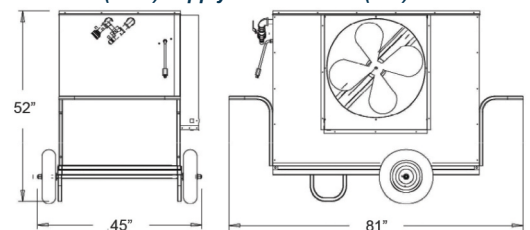

Dimensions: 81" l x 45" w x 52" h